

PRE-PRODUCTION PREVIEW

MODEL Z AIR 285

Standard Run MSRP \$89,009

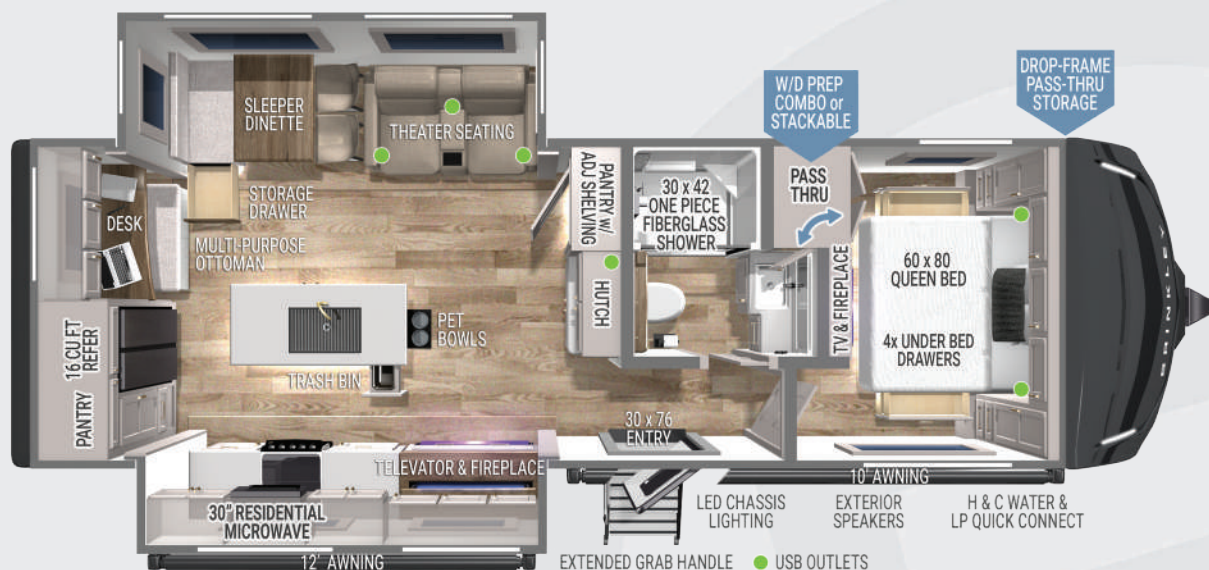

SPECIFICATIONS:

- UVW – 9,242 lbs.
- GVWR – 12,395 lbs.
- Hitch Weight – 890 lbs.
- Exterior Length – 33' 11"
- Overall Height w/ AC – 11' 7"
- Width – 96"
- Interior Height – 84"
- Slide Height – 72.5"
- Axles – Tandem 6,000 lbs.
- Wheels & Tires – 16" E-Rated
- Fresh Water Capacity – 62 gal
- Gray Water Capacity – 80 True + 30 gal
- Black Water Capacity – 40 gal
- Insulation – Floors/Ceiling R40, Walls R9

FEATURES:

- Sleeper Dinette w/ Storage Drawer
- Desk w/ Overhead Cabinet Storage
- Solid Surface Countertops
- Brinkley CraftSense™ Wood Trim Construction
- Premium Residential Cabinets & Drawers w/ Dovetail Joints
- Kitchen & Living Room Flush Floor Slides
- 18k Variable Speed Chill Cube Main AC & Bedroom AC
- Pull-Out Trash Bin w/ Utility Storage
- Large Pantry w/ Adjustable Shelves & Appliance Outlet
- 13 Outlets & 3 Outlets w/ USB & USB-C
- Pet Feeder w/ Removable Pet Bowls
- 5,000 BTU Electric Fireplace in Bedroom
- Built-In Bedside Storage & Outlets w/ USB & USB-C
- Rockford Stereo w/ App Control + Subwoofer Prep

- Queen Bed w/ Residential 7" Memory Foam Mattress (60"x80") & Under-Bed Storage Drawers
- Under-Bed Locking Safe
- One-Piece Fiberglass Shower Surround w/ Seat
- Square Euro Frameless Windows w/ 6" Openings
- Integrated Window Screens & Insulated Blackout Blinds (No Valances)
- Brinkley Automotive-Grade Sealant Package
- Automotive-Grade Front Cap, Lights, & Lens
- Sleek Styling w/ Automotive-Grade Exterior Graphics
- 2 - Hot/Cold Outdoor Showers (BOTH sides of coach)
- Tankless On-Demand Water Heater
- Heated Enclosed Underbelly (Circulated)
- Custom LP Box w/ Battery Storage

- One Touch Automatic Leveling System
- Drop Frame Chassis w/ Motion Lighting & Power Outlets
- Premium Utility Center w/ Retractable 65' Water Hose
- Industry First Brass Plumbing Connections
- Industry First Low Maintenance Roof
- Heated Tanks w/ Electric Waste Valves w/ Manual-Override
- E-Rated Hankook Tires & 16" Aluminum Custom Wheels
- Anti-Lock Brakes w/ Anti-Sway & Dynamic Brake Boost
- 370W Solar Panel w/ 60AMP MPPT Controller (Inverter Prep & Lithium Ready)

FACTORY OPTIONS:

- Dual Pane Windows \$1,731

Optional equipment & props may be shown.
All content is subject to change without notice.
Please consult with your dealer for current information.

LaMesa REC VAN
LaMesaRV.com
800-496-8778

BRINKLEY

For More Information, Photos, Videos
& Why Brinkley go to **BrinkleyRV.com**



120324

MODEL Z AIR 295

Standard Run MSRP \$86,620



SPECIFICATIONS:

- UVW – 9,168 lbs.
- GVWR – 11,995 lbs.
- Hitch Weight – 870 lbs
- Exterior Length – 34' 9"
- Overall Height w/ AC – 11' 7"
- Width – 96"
- Interior Height - 84"
- Slide Height - 72.5"
- Axles – Tandem 6,000 lbs.
- Wheels & Tires – 16" E-Rated
- Fresh Water Capacity – 62 gal
- Gray Water Capacity – 80 gal (True)
- Black Water Capacity – 40 gal
- Insulation – Floors/Ceiling R40, Walls R9

FEATURES:

- Flip-Down Island Bar w/ Stools
- Solid Surface Countertops
- Brinkley CraftSense™ Wood Trim Construction
- Premium Residential Cabinets & Drawers w/ Dovetail Joints
- Kitchen & Living Room Flush Floor Slides
- 18k Chill Cube Main AC & Bedroom AC
- Pull-Out Trash Bin w/ Utility Storage
- Large Pantry w/ Adjustable Shelves & Appliance Outlet
- 14 Outlets & 4 Outlets w/ USB & USB-C
- Pet Feeder w/ Removable Pet Bowls
- Stacked Rear Bunks w/ Double Mattresses (54"x74")
- Built-In Bedside Storage & Outlets w/ USB & USB-C
- Rockford Stereo w/ App Control + Subwoofer Prep

- One-Piece Fiberglass Shower Surround w/ Seat
- Square Euro Frameless Windows w/ 6" Openings
- Integrated Window Screens & Insulated Blackout Blinds (No Valances)
- Brinkley Automotive-Grade Sealant Package
- Automotive-Grade Front Cap, Lights, & Lens
- Sleek Styling w/ Automotive-Grade Exterior Graphics
- 2 - Hot/Cold Outdoor Showers (BOTH sides of coach)
- Tankless On-Demand Water Heater
- Heated Enclosed Underbelly (Circulated)
- Drop Frame Chassis w/ Over 100 Cubic Feet of Exterior Storage (Accessible Campside) w/ Motion Lighting & Power Outlets
- Custom LP Box w/ Battery Storage

- One Touch Automatic Leveling System
- Premium Utility Center w/ Retractable 65' Water Hose
- Industry First Brass Plumbing Connections
- Industry First Low Maintenance Roof
- Heated Tanks w/ Electric Waste Valves w/ Manual-Override
- E-Rated Hankook Tires & 16" Aluminum Custom Wheels
- Anti-Lock Brakes w/ Anti-Sway & Dynamic Brake Boost
- 370W Solar Panel w/ 60AMP MPPT Controller (Inverter Prep & Lithium Ready)

FACTORY OPTIONS:

- Dual Pane Windows \$1,731

Optional equipment & props may be shown.
All content is subject to change without notice.
Please consult with your dealer for current information.

LaMESA **RV**
LaMesaRV.com
800-496-8778

BRINKLEY

For More Information, Photos, Videos
& Why Brinkley go to **BrinkleyRV.com**



120324

PRE-PRODUCTION PREVIEW

MODEL Z AIR 297

Standard Run MSRP \$92,863

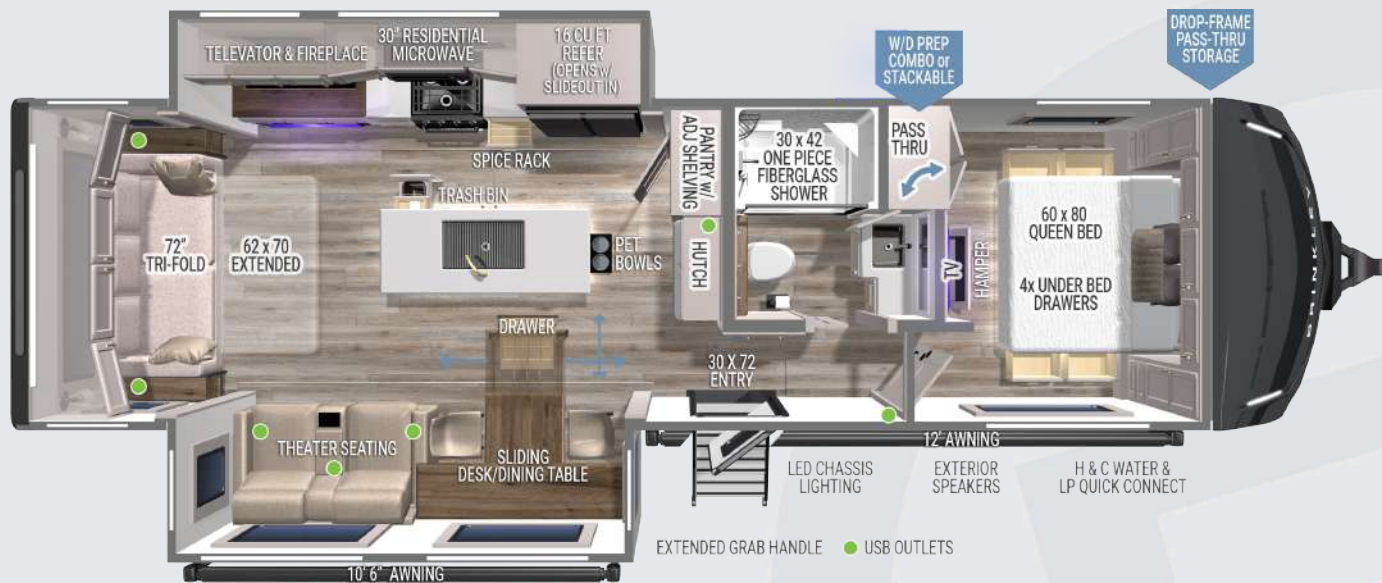

SPECIFICATIONS:

- UVW – 10,297 lbs.
- GVWR – 13,495 lbs.
- Hitch Weight – 989 lbs
- Exterior Length – 34' 11"
- Overall Height w/ AC – 11' 9"
- Width – 96"
- Interior Height - 84"
- Slide Height - 72.5"
- Axles – Tandem 7,000 lbs.
- Wheels & Tires – 16" G-Rated
- Fresh Water Capacity – 62 gal
- Gray Water Capacity – True 75 gal
- Black Water Capacity – 45 gal
- Insulation – Floors/Ceiling R40, Walls R9

FEATURES:

- Sliding Desk/Dining Table w/ Extending Leaves & Storage Drawer (Seats up to 4)
- 72" Trifold Sofa w/ 62"x70" Sleeper
- Solid Surface Countertops
- Brinkley CraftSense™ Wood Trim Construction
- Premium Cabinets & Drawers w/ Dovetail Joints
- Kitchen & Living Room Flush Floor Slides
- 18k Chill Cube Main AC & Bedroom AC
- Pull-Out Trash Bin w/ Utility Storage
- Large Pantry w/ Adjustable Shelves & Appliance Outlet
- 14 Outlets & 4 Outlets w/ USB & USB-C
- Queen Bed w/ Residential 7" Memory Foam Mattress (60"x80") & Under-Bed Storage Drawers
- Under-Bed Locking Safe
- Pet Feeder w/ Removable Pet Bowls

- Rockford Stereo w/ App Control + Subwoofer Prep
- Built-In Bedside Storage & Outlets w/ USB & USB-C
- 5,000 BTU Electric Fireplace in Bedroom
- One-Piece Fiberglass Shower Surround w/ Seat
- Square Euro Frameless Windows w/ 6" Openings
- Integrated Window Screens & Insulated Blackout Blinds (No Valances)
- Brinkley Automotive-Grade Sealant Package
- Automotive-Grade Front Cap, Lights, & Lens
- Sleek Styling w/ Automotive-Grade Exterior Graphics
- 2 - Hot/Cold Outdoor Showers (BOTH sides of coach)
- Tankless On-Demand Water Heater
- Heated Enclosed Underbelly (Circulated)
- Custom LP Box w/ Battery Storage
- One Touch Automatic Leveling System

- Drop Frame Chassis w/ Over 100 Cubic Feet of Exterior Storage (Accessible Campsite) w/ Motion Lighting & Power Outlets
- Premium Utility Center w/ Retractable 65' Water Hose
- Industry First Brass Plumbing Connections
- Industry First Low Maintenance Roof
- Heated Tanks w/ Electric Waste Valves w/ Manual-Override
- G-Rated Hankook Tires & 16" Aluminum Custom Wheels
- Anti-Lock Brakes w/ Anti-Sway & Dynamic Brake Boost
- 370W Solar Panel w/ 60AMP MPPT Controller (Inverter Prep & Lithium Ready)

FACTORY OPTIONS:

- Dual Pane Windows \$1,731

011625

Optional equipment & props may be shown.
All content is subject to change without notice.
Please consult with your dealer for current information.

LaMESA REC VAN

LaMesaRV.com
800-496-8778

BRINKLEY

For More Information, Photos, Videos
& Why Brinkley go to **BrinkleyRV.com**



MODEL Z AIR 310

Standard Run MSRP \$100,014

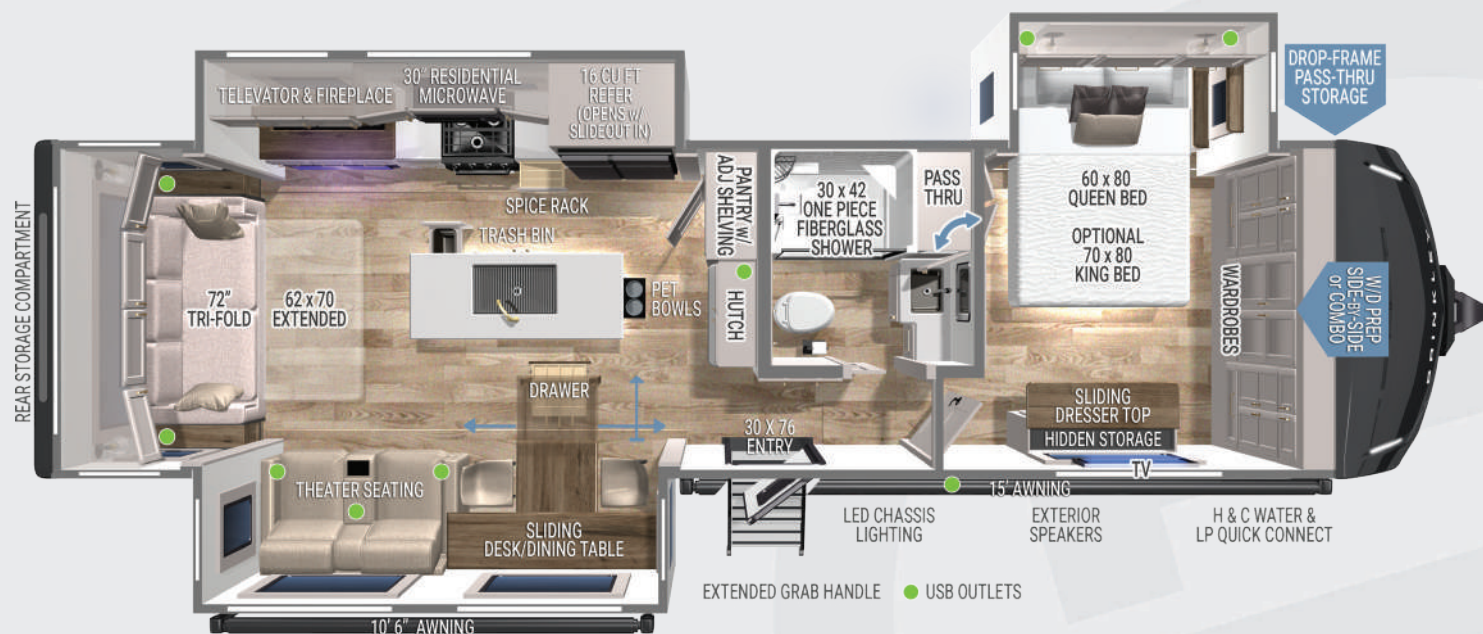

SPECIFICATIONS:

- UVW – 10,961 lbs.
- GVWR – 14,495 lbs.
- Hitch Weight – 1,086 lbs.
- Exterior Length – 37' 10"
- Overall Height w/ AC – 11' 9"
- Width – 96"
- Interior Height – 84"
- Slide Height – 72.5"
- Axles – Tandem 7,000 lbs.
- Wheels & Tires – 16" G-Rated
- Fresh Water Capacity – 62 gal
- Gray Water Capacity – 75 True + 30 gal
- Black Water Capacity – 45 gal
- Insulation – Floors/Ceiling R40, Walls R9

FEATURES:

- Sliding Desk/Dining Table w/ Extending Leaves & Storage Drawer (Seats up to 4)
- 72" Trifold Sofa w/ 62"x70" Sleeper
- Solid Surface Countertops
- Brinkley CraftSense™ Wood Trim Construction
- Premium Residential Cabinets & Drawers w/ Dovetail Joints
- Kitchen & Living Room Flush Floor Slides
- 18k Chill Cube Main AC & Bedroom AC
- Pull-Out Trash Bin w/ Utility Storage
- Large Pantry w/ Adjustable Shelves & Appliance Outlet
- Pet Feeder w/ Removable Pet Bowls
- Washer/Dryer Prep (Combo or Side by Side)
- Rockford Stereo w/ App Control + Subwoofer Prep
- One-Piece Fiberglass Shower Surround w/ Seat
- Square Euro Frameless Windows w/ 6" Openings
- Integrated Window Screens & Insulated Blackout Blinds (No Valances)
- Brinkley Automotive-Grade Sealant Package
- Automotive-Grade Front Cap, Lights, & Lens
- Sleek Styling w/ Automotive-Grade Exterior Graphics
- 2 - Hot/Cold Outdoor Showers (BOTH sides of coach)
- Tankless On-Demand Water Heater
- Heated Enclosed Underbelly (Circulated)
- Custom LP Box w/ Battery Storage
- One Touch Automatic Leveling System
- Drop Frame Chassis w/ Motion Lighting & Power Outlets
- Premium Utility Center w/ Retractable 65' Water Hose
- Industry First Brass Plumbing Connections
- Industry First Low Maintenance Roof
- Heated Tanks w/ Electric Waste Valves (Manual-Override)
- G-Rated Hankook Tires & 16" Aluminum Custom Wheels
- Anti-Lock Brakes w/ Anti-Sway & Dynamic Brake Boost
- 370W Solar Panel w/ 60AMP MPPT Controller (Inverter Prep & Lithium Ready)

FACTORY OPTIONS:

- Dual Pane Windows \$1,731
- King Bed \$0

Optional equipment & props may be shown.
All content is subject to change without notice.
Please consult with your dealer for current information.

LaMESA **RV**
LaMesaRV.com
800-496-8778

BRINKLEY

For More Information, Photos, Videos
& Why Brinkley go to **BrinkleyRV.com**



120324